

DIMENSIONS OF THE SCALE

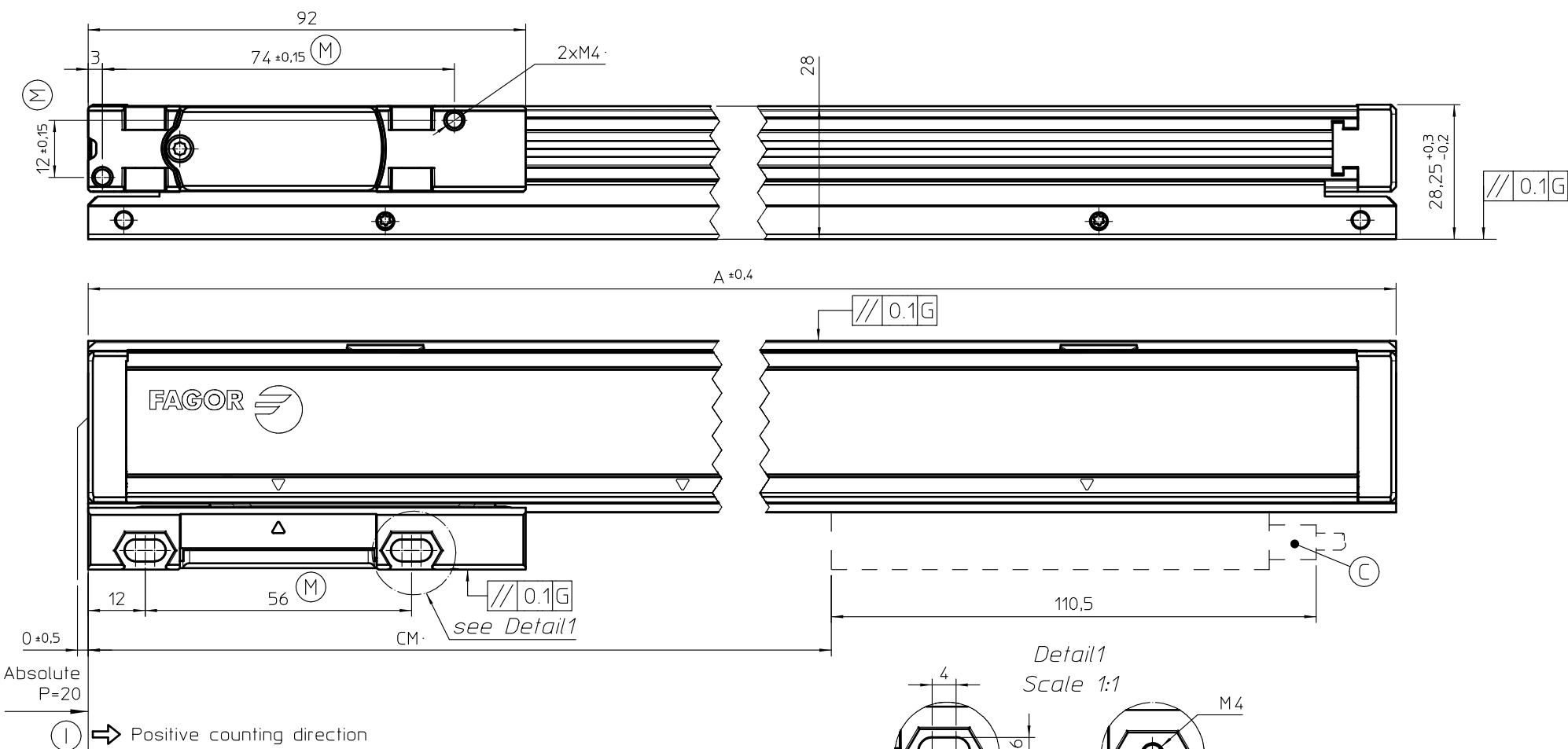

DIMENSIONS OF THE SUPPORT OF THE SCALE

Scale: 1:2

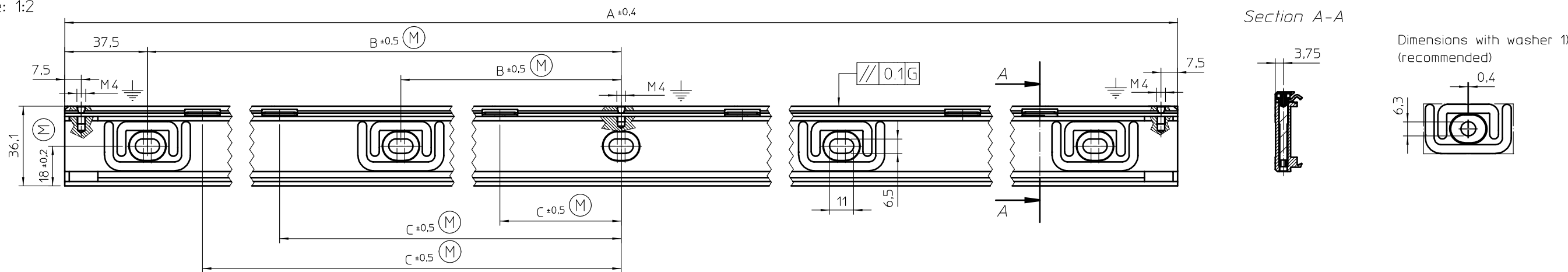

SCALE MOUNTING OPTIONS: HEAD (N1)

STANDARD HEAD

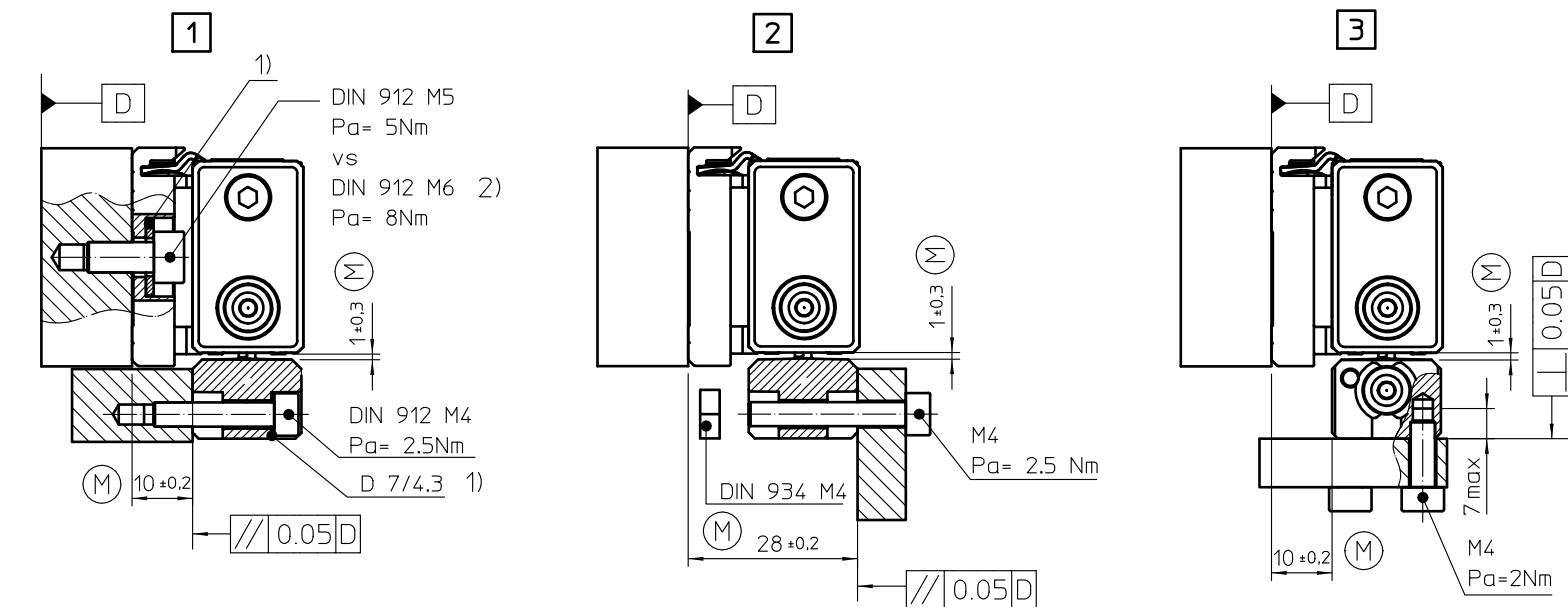

OPTIONAL HEAD

Note: rest of dimensions same of the standard head dimensions

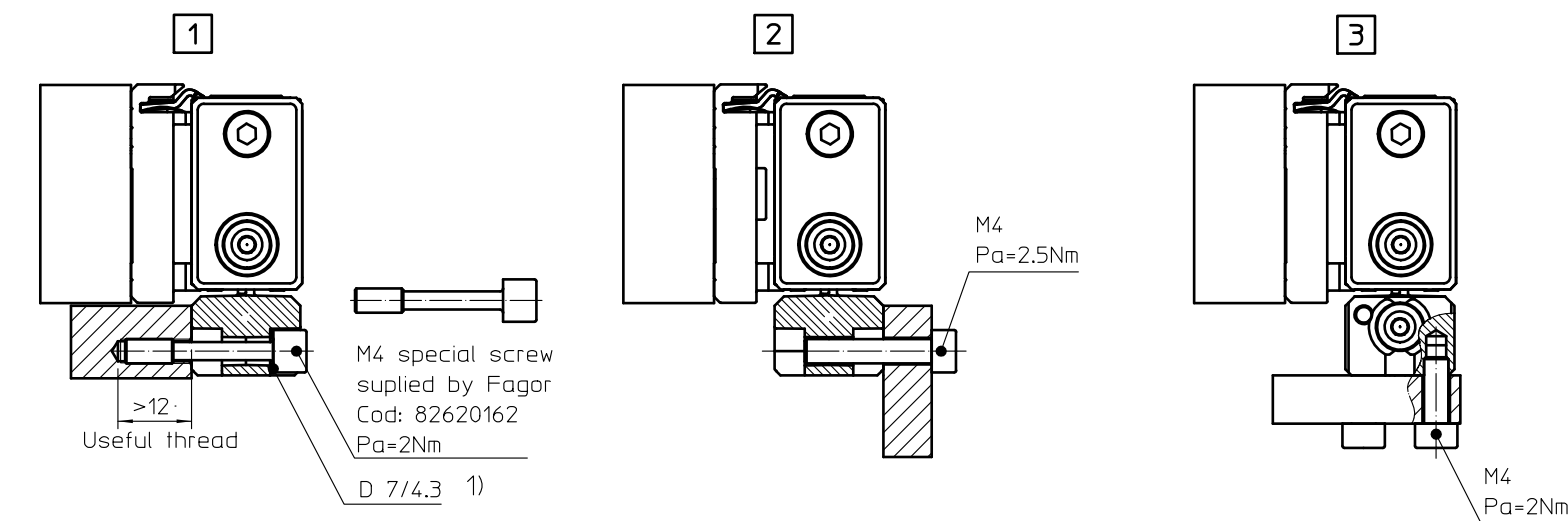

SCALE MOUNTING OPTIONS: SUPPORT (N1)

ON MACHINED SURFACE

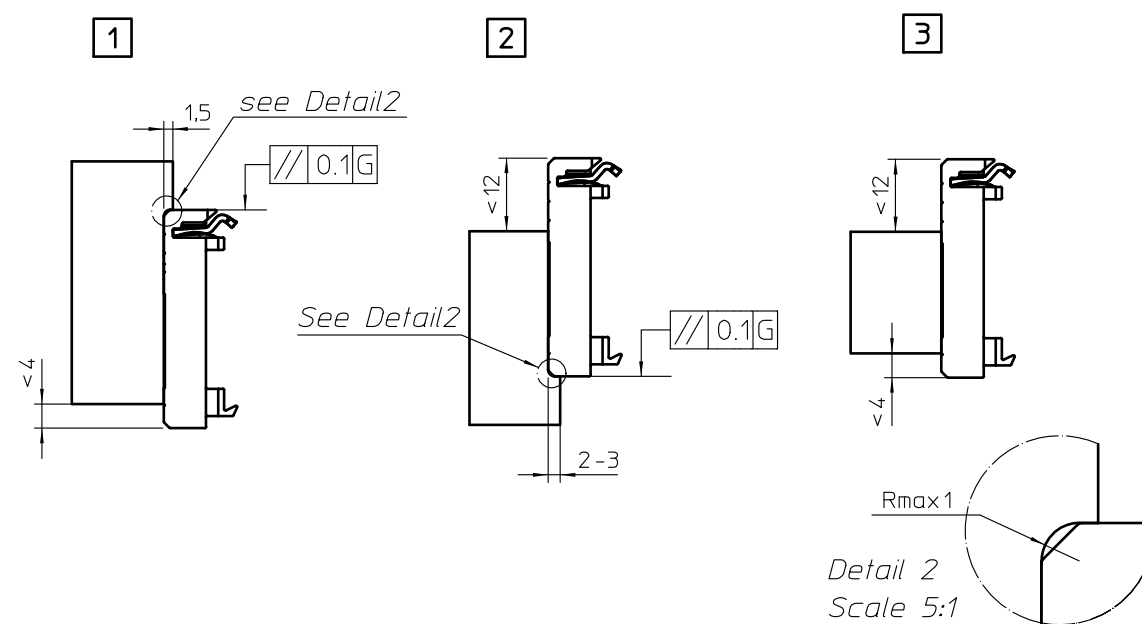

ON PINS

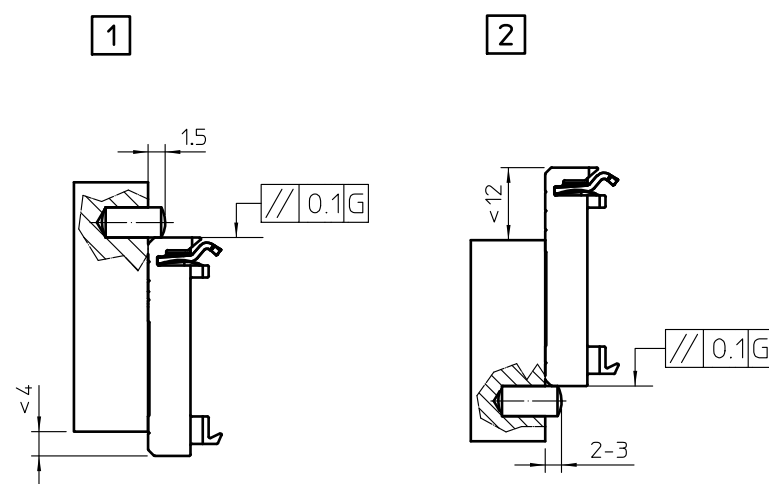

ABBREVIATIONS

- (M) = Assembly sizing set by customer
(C) = Connector can be connected to both sides
(R) = Can connect air intake to both sides
① = Beginning of the measuring length
(N1) = Mounting surfaces and threads must be clean and free of paint and grease
CM = Measuring length
G = Machine guideway
Pa = Tightening torque
1) = Items supplied
2) = For Functional Safety Mechanical Fault Exclusion only M6 screws are allowed for the fixation of the spar

HOLE AND CLAMP POSITIONS FOR DIFFERENT MEASURING LENGTHS

CM	A	B (Position of holes in the machine)	C (Position of clamps of scale)
70	175	50	37.5
120	225	75	55
170	275	100	75
220	325	125	100
270	375	150	115, 55
320	425	175	140, 55
370	475	200	175, 55
420	525	225	200, 55
470	575	250	225, 55
520	625	275	250, 55
570	675	300, 200,	275, 55
620	725	325, 200,	300, 55, 255
670	775	350, 200,	325, 55, 255
720	825	375, 200,	350, 55, 255
770	875	400, 200,	375, 55, 255
820	925	425, 200,	400, 55, 255
870	975	450, 200,	425, 55, 255
920	1025	475, 200,	450, 55, 255
970	1075	500, 400, 200,	475, 55, 255
1020	1125	525, 400, 200,	500, 55, 255, 455
1070	1175	550, 400, 200,	515, 55, 255, 455
1140	1245	585, 400, 200,	555, 55, 255, 455
1240	1345	635, 400, 200,	610, 55, 255, 455
1340	1445	685, 400, 200,	655, 55, 255, 455
1440	1545	735, 600, 400, 200	710, 55, 255, 455, 655
1540	1645	785, 600, 400, 200	760, 55, 255, 455, 655
1640	1745	835, 600, 400, 200	810, 55, 255, 455, 655
1740	1845	885, 600, 400, 200	855, 55, 255, 455, 655
1840	1945	935, 800, 600, 400, 200	910, 55, 255, 455, 655, 855
2040	2145	1035, 800, 600, 400, 200	1010, 55, 255, 455, 655, 855

DIFFERENT TYPES OF CONNECTOR CABLES

- (E1) = Three different types of cable
- Cable $\phi 6$ mm
- Cable $\phi 4$ mm
- Cable $\phi 10.5$ mm (with protection)

- Bend radius for flexible configuration for:
- Cable $\phi 6$ mm: $R > 60$ mm
- Cable $\phi 4$ mm: $R > 40$ mm
- Cable $\phi 10.5$ mm: $R > 60$ mm

- Bend radius for rigid configuration for:
- Cable $\phi 6$ mm: $R > 24$ mm
- Cable $\phi 4$ mm: $R > 16$ mm
- Cable $\phi 10.5$ mm: $R > 35$ mm

- (E2) = Cable support

ANNOTATIONS

- 1.- In safety-related applications:
- An anti-rotation lock (medium strength adhesive) is to be used for screws
- A2 class 70 or higher or 8.8 or higher screws must be used.
- Non stainless screws can only be used if the corrosion fault made is excluded.

Rev.	Summary	Propo.	App.	Date	Scale: 1:1,25
N°	Designation	Quant.	Material	Finish	Dimensions in mm
Drawing N	PT-2-003-1	Date	2020/06/18	Fagor Automation S. Coop. 20500 Mondragón	Tolerancing ISO 8015 ISO 2768 - m H < 6 mm: ±0.2 mm
Replaces		Design by	Aitor		
		Check by	Zunzu		